

Application Check list for **Temporary Tent** floor plan. (Refer to code sections for specific requirements)

- The drawing needs be on graph paper
- The drawing needs to be done to scale
- The drawing needs dimensions listed
- The drawing needs to show the direction the building faces
- List hours of operations (7.4.8.3)
- List building area in square ft. (7.3.6, 7.3.9)
- List retail area in square ft. (7.4.5)
- List display area in square ft. (7.4.10)
- List open floor area in square ft. (7.3.20)
- Draw interior layout (7.3.14, 7.3.20)
- Label the location of the cash register
- Label overall building dimensions
- Label the location of openings and widths (7.4.8.5)
- Label location of fire extinguishers and types (7.3.8)
- Label location of all required postings (7.3.11, 7.3.13, 7.4.8.2)
- Label location of exit signs (7.3.14.5.1, 7.3.14.5.2)
- Label location of interior and exterior egress lighting (7.3.14.6.1, 7.3.14.6.2)
- Label Flame break locations (7.3.15, 7.4.11)
- Label the intended use of all sales display that do not require flame breaks (7.3.15, 7.4.11)
- The drawing must be clear, legible, and as detailed as possible
- Read NFPA 1124 Permanent Facility Compliance List
- Other information may be required during the review process

# 30' x 30' Tent

1234 Fireworks Rd  
Anytown, IA 50000

Tent Area: 900 SF  
Retail Area: 900 SF  
Display Area: 288 SF  
Floor Area: 596 SF

## Hours of Operation

10AM - Dusk

\* Not open after Dusk

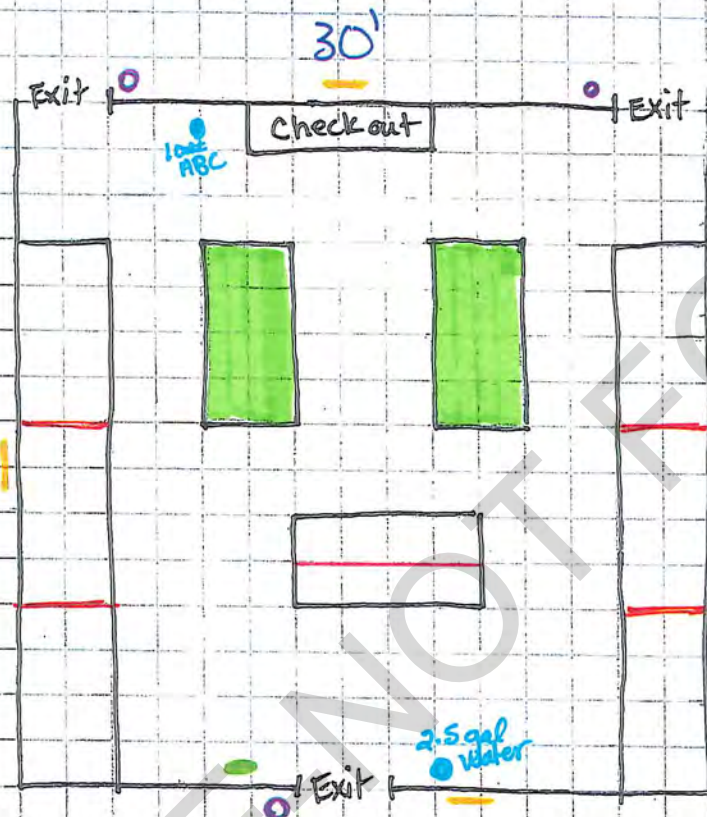

Exit = Exit Sign

- = Flame Break

● = Fire Extinguisher

● = Evacuation Plan

- = No Fireworks Discharge w/ 300 ft

○ = No Smoking Signs

\* No merchandise over 6' tall

\* No tables over 6' tall

\* All exits are 44" or more

□ = 2' x 2'

■ = Packaged Fireworks Display

1234 Anyroad  
Anywhere, IA 50000

40'x60' Tent

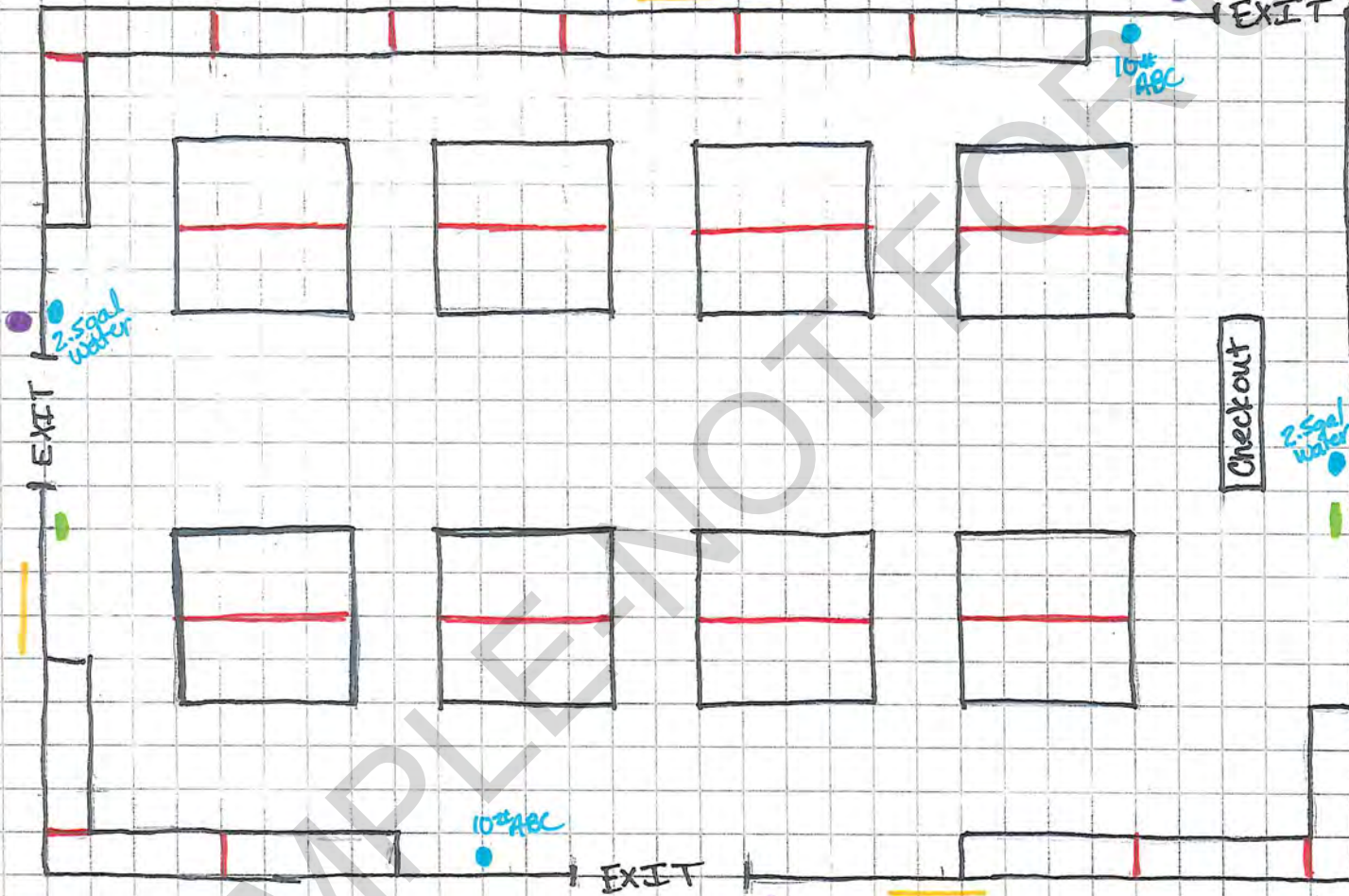

- = Evacuation Plan
  - = Flame Break
  - = No Smoking Sign
  - = No Fireworks Discharging w/ 30'
  - = Fire Extinguisher
- Exit: Illuminated Exit sign & emergency light w/ battery backup

- Notes
- \* No merchandise over 6'
  - \* No tables or shelving over 6'
  - \* All exits 44" or more

□ = 2'x2'

Hours of Operation:  
10AM - Midnight  
\* Open after Dusk

Tent Area: 2400 SF  
Retail Area: 2400 SF  
Display Area: 720 SF  
Floor Area: 11664 SF

▭ = 4'x8' table  
▭ = 2'x8' table

60' x 60' Tent

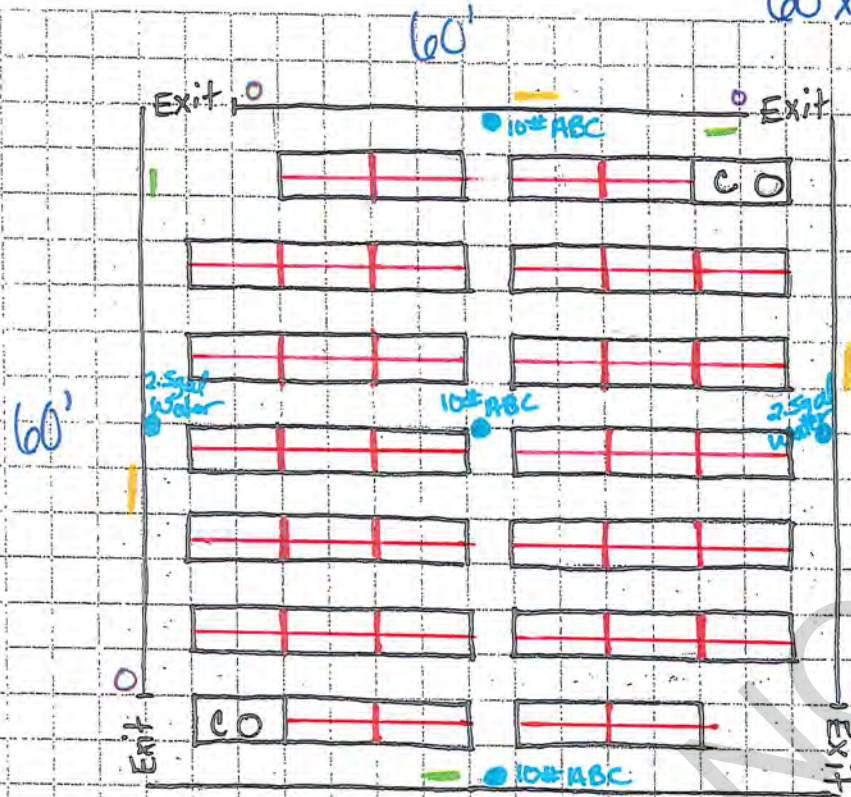

1234 Fireworks Rd  
Anytown, IA 50000

Tent Area: 3600 SF  
Retail Area: 3600 SF  
Display Area: 1216 SF  
Floor Area: 2320 SF

□ = 4' x 4'

Business Hours

10AM - Midnight  
\* open AFTER Dusk

- CO = Check Out
- = Flame Break
- = Fire Extinguisher
- = Evaluation Plan
- = No Fireworks Discharge w/ 300' sign
- = Fireworks - No Smoking sign

Exit = Illuminated Exit sign & Emergency lighting unit w/ battery Backup

\* All exits 44" or more

\* No merchandise over 6' off the ground

\* No tables over 6' off the ground