

GENERAL INFORMATION		
LOCATION OF PROJECT:	Project Title Street Address Des Moines, IA 50309 Parcel No. 000/00000-000-000	ARCHITECT: Architect Street Address Des Moines, IA 50309 State of Iowa Registration No.
STRUCTURAL ENGINEER:	Structural Engineer Street Address Des Moines, IA 50309 State of Iowa Registration No.	M/E/P ENGINEER: Mechanical Engineer Street Address Des Moines, IA 50309 State of Iowa Registration No.

PROJECT DESCRIPTION
A brief Description of the project.

APPLICABLE CODES	CODES/REGS. UTILIZED IN DESIGN
2015 - International Building Code 2018 - International Mechanical Code 2018 - Uniform Plumbing Code 2015 - International Fuel Gas Code 2012 - International Energy Code	2015 - International Existing Building Code 2017 - National Electrical Code 2015 - International Fire Code 2010 - ADAAG

BUILDING HEIGHTS AND AREAS (Chapter 5)	
Basic Allowable Type B Occupancy, Type V-B - 1 story not to exceed 40'-0" above grade, 9000 s.f.	Actual Building Areas Level 1 5854 SF Grand total 5854 SF
Proposed Building 5,854 CSF, 1 Story, total building height 16'-8" above grade Building Perimeter Building Frontage	

OCCUPANCY TYPE (Chapter 3)	
B - Business	4393 SF
U - Utility	921 SF

TYPES OF CONSTRUCTION (Chapter 6)	
Construction Type: VB	
Structural Fire Ratings (Table 601)	
Structural frame including columns, girders & trusses	0 hr.
Bearing exterior walls	0 hr.
Bearing interior walls	0 hr.
Nonbearing exterior walls & partitions	0 hr.
Nonbearing interior walls & partitions	0 hr.
Floor construction including supporting beams & joists	0 hr.
Roof construction including supporting beams & joists	0 hr.
Fire Resistance Rating - Exterior Walls (Table 602)	
Type V-B	
<5'	1hr.
> 5' <10'	1hr.
> 10' <30'	1hr.
> 30'	0hr.
Exterior Opening Requirements (Table 704.8)	No Limit

FIRE PROTECTION FEATURES		WATER SUPPLY - FLOW TESTS	
Fire Alarm:	Not Required/Not Provided	Static:	
FACP:	Not Required/Not Provided	Residual:	
Remote Annunciator Panel:	Not Required/Not Provided	Flow:	
Smoke Detection:	Required/Provided: Location	Date and Location:	
Heat Detection:	Not Required/Not Provided	Date of Original System Installation:	
Fire Pump:	Not Required/Not Provided		
Backup Power:	Not Required/Not Provided		
Suppression - Standpipes:	Not Required/Not Provided		
Suppression - Automatic:	Not Required/Not Provided		
Fire Extinguishers:	Required/Provided: Per NFPA 10		
Type I Commercial Hoods:	Not Required/Not Provided		

MEANS OF EGRESS (Chapter 10)	
1004 DESIGN OCCUPANT LOADS	1013.1 EXIT SIGNS 100 feet or viewable.
OFFICE NET SF / 100 SF = 48	1013.5 Exit signs shall be internally or externally illuminated.
UTILITY NET SF / 300 SF = 4	
TOTAL OCCUPANTS = 52	
1005.1 EGRESS WIDTHS - SEE BELOW	1017.2 TRAVEL DISTANCE B 200 feet
EGRESS WIDTH REQ. 10.4 Total inches	1020.1 CORRIDORS "Minimum width is 44".
5.2 Second exit	1020.4 Dead ends B is 20 feet
1008 MEANS OF EGRESS ILLUMINATION Required for A2/M/B/R-2 corridors	1022 MIN NUMBER OF EXITS 2 exits required
1009.1 Accessible means of egress Two required	1028 Exit Discharge Exits shall discharge directly to exterior of building
1009.1.1 "Min. clear width of 32" measured from the face of the door and the stop with the door open 90 degrees."	
1009.1.2 Doors shall swing in the direction of egress travel where serving an occupant load of 50 or more.	

ACCESSIBILITY, VENTILATION & MIN. VALUES	
"Sites, buildings, structures, facilities shall be accessible to persons with physical disabilities" ADA - 2010	
208.2	PARKING - 3 accessible space required
208.2.4	1 Van space Required
Ventilation in accordance with State Mechanical Code	
Chapter 14	Exterior walls 'R' value is R-19 min. and Roof 'R' value is R-23 min.
Chapter 15	Roof will be class C or better (flame spread)

PLUMBING FIXTURES (2015 UPC)	
OCCUPANT LOADS FOR DETERMINING REQUIRED PLUMBING FIXTURES	
Non-Accessory Spaces	4,000 SF NET / 200 SF = 20 TOTAL OCCUPANTS (10 MALE, 10 FEMALE)
PLUMBING FIXTURES REQUIRED	
Table 2902.1 - 2015 International Building Code	
	WC'S (MALE) (FEMALE) URN LAV DF 1 per 100
GROUND FLOOR PROVIDED	1 1 0 2 1
	1 1 0 2 0

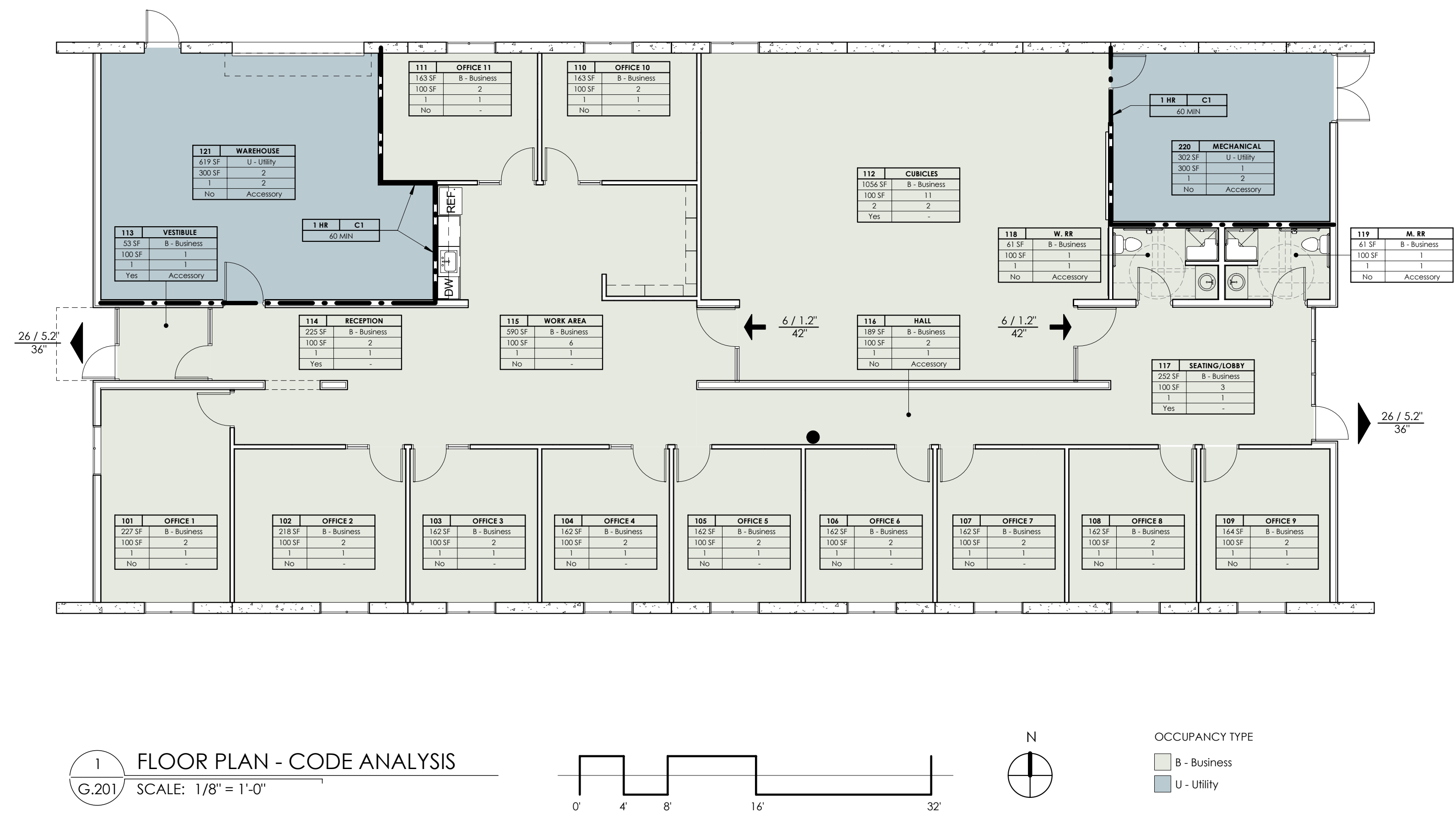

1 FLOOR PLAN - CODE ANALYSIS
SCALE: 1/8" = 1'-0"

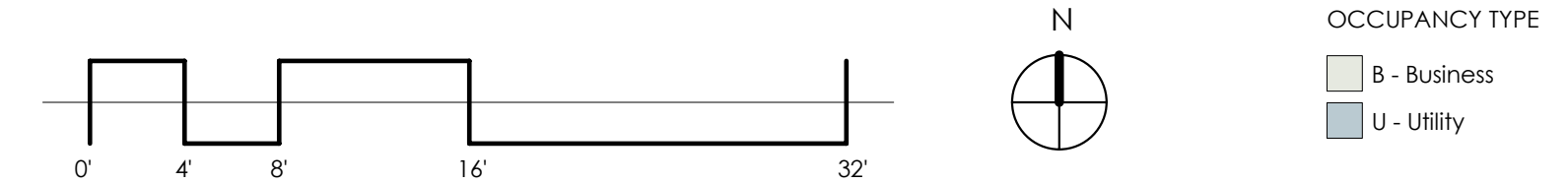

CODE PLAN LEGEND

SYMBOL	DESCRIPTION	SYMBOL	DESCRIPTION	NOTES
▶	EXIT - EXTERIOR	—•—•—	1 FIRE BARRIER (OCCUPANCY SEPARATION)	1 HOUR F.R. WALL CONSTRUCTION, 3/4 HOUR RATED DOOR ASSEMBLIES, FIRE & SMOKES DAMPERS.
•	EXIT - INTERIOR	—•••—	2 FIRE BARRIER (OCCUPANCY SEPARATION)	2 HOUR F.R. WALL CONSTRUCTION, 1 1/2 HOUR RATED DOOR ASSEMBLIES, FIRE & SMOKES DAMPERS.
•	FIRE EXTINGUISHER	—••••—	3 FIRE BARRIER (OCCUPANCY SEPARATION)	3 HOUR F.R. WALL CONSTRUCTION, 3 HOUR RATED DOOR ASSEMBLIES, FIRE & SMOKES DAMPERS.
▨	EXISTING CONSTRUCTION	—•••••—	4 FIRE BARRIER (OCCUPANCY SEPARATION)	4 HOUR F.R. WALL CONSTRUCTION, NO OPENINGS.
□	NEW CONSTRUCTION	198 / 39.6"	OCCUPANTS / REQUIRED WIDTH PROVIDED WIDTH	

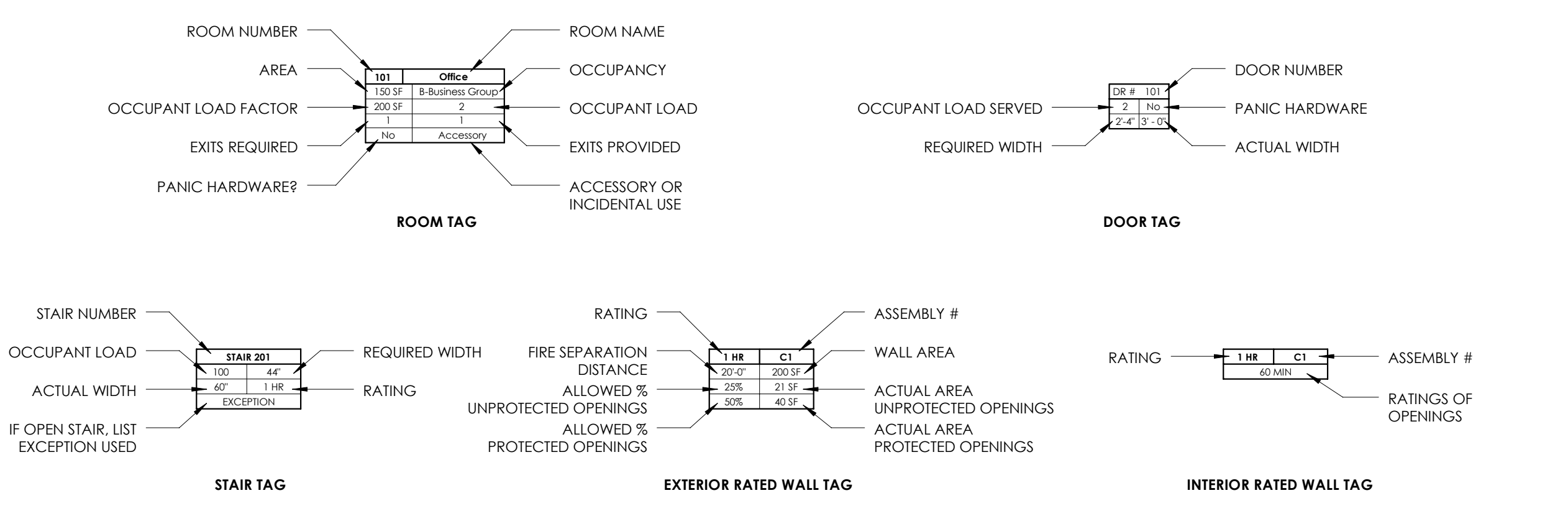

LAST PLOTTED: 8/6/2019 12:09:08 PM

SCHEME A

PROJECT TITLE
PROJECT ADDRESS

SHEET AUTHOR NAME	2019-05
CHECKED BY NAME	
PROJECT MANAGER NAME	
ISSUE DATE	

ISSUE DATE	ISSUE TITLE
DATE	PERMIT SET

NO.	REVISION SCHEDULE	DATE
	DESCRIPTION	

ISSUED FOR CONSTRUCTION

SHEET NAME	CODE ANALYSIS
SHEET NUMBER	G.201